

Walsgrave Gardens, Coventry

We've carried out some works to help improve your estate

- Cleared and cleaned pathways
- Painted brickwork, garage doors and gates
- Painted and replanted the planters
- Removed moss on all Orbit-owned roofs
- Removed fly-tipped rubbish
- Cleared and fixed guttering



Before



After



Before



After



Scan me to let us know what you think of our proposals and find out more about our customer panel

Walsgrave Gardens, Coventry

Our vision for the future of Walsgrave Gardens

- Better access for pedestrians, including improved routes through the estate and more obvious 'wayfinding' so Walsgrave Gardens is easier to get around
- Better parking solutions so that informal parking doesn't dominate the estate
- Better natural surveillance across the estate, with more active frontages so pathways are overlooked and residents feel safer
- Better public open spaces and more green space to improve the appearance of the estate



**Do you agree
with our vision?**

Scan the QR code to visit the Walsgrave Gardens webpage and fill in the feedback form. Let us know what you think and make suggestions for any future changes you'd like to see at Walsgrave Gardens.



Scan me to let us know what you think of our proposals and find out more about our customer panel

We've worked with our architects to produce some draft designs for changes at Walsgrave Gardens, please take a look and give us your feedback.

Walsgrave Gardens, Coventry

Walsgrave Gardens Draft Designs

Our proposed improvements to car parking

Boswell Drive

- Define parking bays. This would result in around 23 bays.
- Demolish eight existing garages.
- Create driveways from Boswell Drive where car parking bays are located, so any reversing into and out of bays is taken off Boswell Drive. We estimate 14 car parking bays.
- Introduce planting in between car parking bays.
- Introduce access to back gardens from driveways to no 158-164 (evens) Boswell Drive.



Proposed plan for garages on Boswell Drive

Walsgrave Gardens

- Define perpendicular car parking bays to one side (the south of the street) and parallel car parking bays to the other side.
- Introduce trees and planting between car parking bays, where no access to garages is required.
- Introduce planting to act as a buffer zone between parallel car parking bays and rear garden walls.



Scan me to let us know what you think of our proposals and find out more about our customer panel

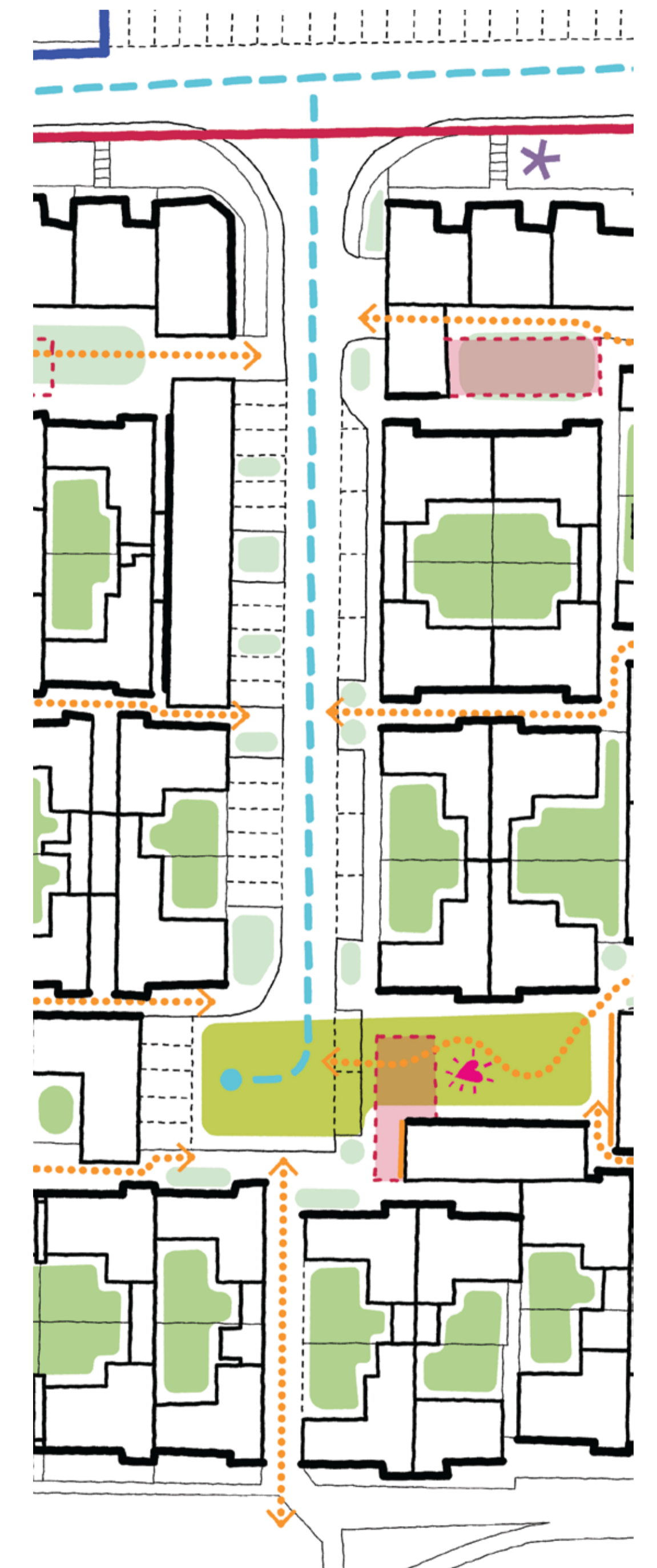

Proposed plan for Walsgrave Gardens

Walsgrave Gardens, Coventry

Walsgrave Gardens Draft Designs

Our proposed improvements to outdoor areas

- Demolish the row of 12 garages on Cumbernauld Walk and Bracknell Walk and create an area of open space including front gardens for no.2-5 Cumbernauld Walk.
- Demolish the row of six garages alongside 81 Bracknell Walk to create a highly visible, open and pleasant street with planting and trees.
- Demolish 81 Bracknell Walk to fully open up the area and allow visibility from Walsgrave Gardens.
- Demolish the row of five garages at the junction of Walsgrave Gardens, Peterlee Walk, Redditch Walk and Basildon Walk to provide a new, large communal green.
- Transform the existing tarmac square into a green space with planting, seating and natural play areas.
- Open up the garages under no.45-53 (odds) Boswell Drive into undercroft open car parking or additional storage for residents.
- Demolish some garages on Boswell Drive to open up Bracknell Walk, Stevenage Walk, Basildon Walk and Redditch Walk, making the area easier to walk around and allow a clearer route through to the retail park.



Scan me to let us know what you think of our proposals and find out more about our customer panel



Sketch of proposed amenity space on Cumbernauld Walk



Sketch of proposed amenity on Peterlee Walk with garages removed

Walsgrave Gardens, Coventry

Timeline

Stage 1: Winter 2024/25 - Spring 2025

- Review customer feedback
- Form customer panel
- Liaise with local authority

Stage 3: Summer 2025 - Spring 2026

- Appoint designer / architect
- Develop new grounds maintenance plan
- Customer consultation
- Submit planning applications

Stage 5: Summer - Autumn 2026

- Progress construction

Stage 2: Summer 2025

- Define design brief
- Update customers on plans

Stage 4: Spring 2026

- Prepare detailed designs
- Appoint contractors

Stage 6: Autumn 2026

- Implement new grounds maintenance plan



Scan me to let us know what you think of our proposals and find out more about our customer panel

Walsgrave Gardens, Coventry

How you can help shape the future of Walsgrave Gardens

Scan the QR code to go straight to the Walsgrave Gardens webpage.

Here you'll find a feedback form where you can let us know:

- If you agree or disagree with our vision for Walsgrave Gardens
- If you support our proposals
- Your suggestions for how we could improve the proposals

On the webpage you can also find out more about our customer panel, including how you can get involved.



Scan me to let us know what you think of our proposals and find out more about our customer panel